

ULINE H-1597
**PORTABLE STRETCH
WRAP DISPENSER**

1-800-295-5510
uline.com

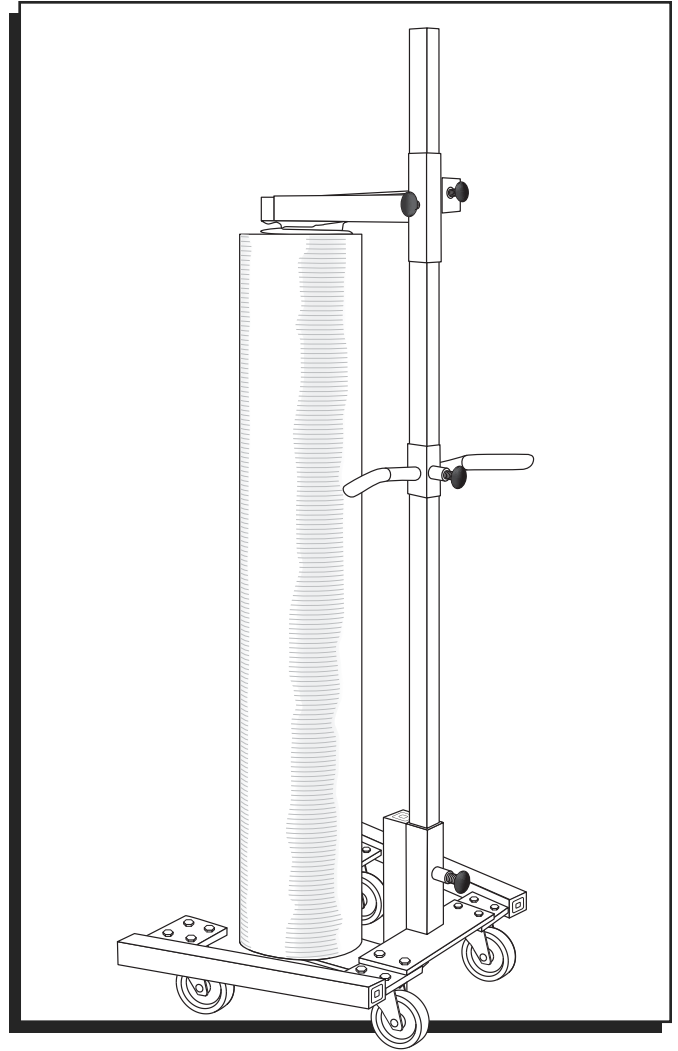

TOOLS NEEDED

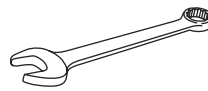

9/16" Crescent Wrench

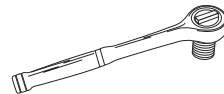

9/16" Socket Wrench

PARTS



COUNT PIECES BEFORE ASSEMBLING



**CONTENTS OF PACKAGE 1
(The Main Post)**

Main Post (black) x 1

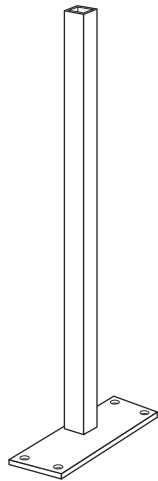

**CONTENTS OF PACKAGE 2
(Head Assembly and Lower Legs)**

Head Assembly x 1

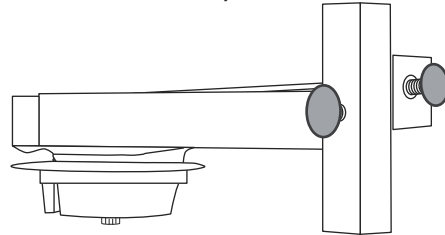

Legs x 2

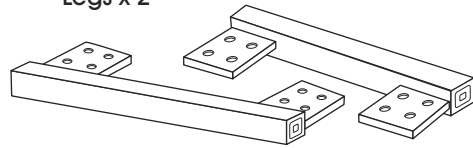

**CONTENTS OF PACKAGE 3
(Film Holder and Steering Handle)**

Film Holder x 1

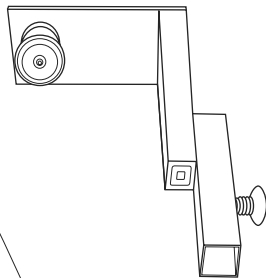

Steering Handle
x 1

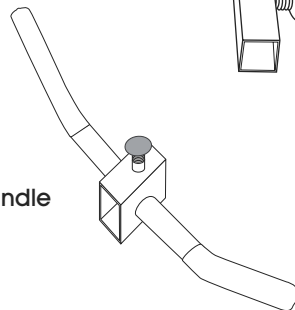

**CONTENTS OF PACKAGE 4
(Casters and Fasteners)**

Swivel Casters x4

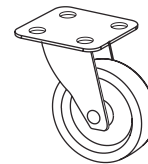

Bolts x 16 Washers x 32 Nuts x 16



ASSEMBLY

FASTEN CASTER TO LEGS

1. Take both legs from Package 1 position them to form a "V".
2. Attach front casters fully using one bolt, one nut, and two washers per hole. (See Figure 1)
3. Attach the rear casters, using only the two holes closest to leg bar.



CAUTION! Do not tighten nuts all the way: this allows other nuts to be positioned correctly.

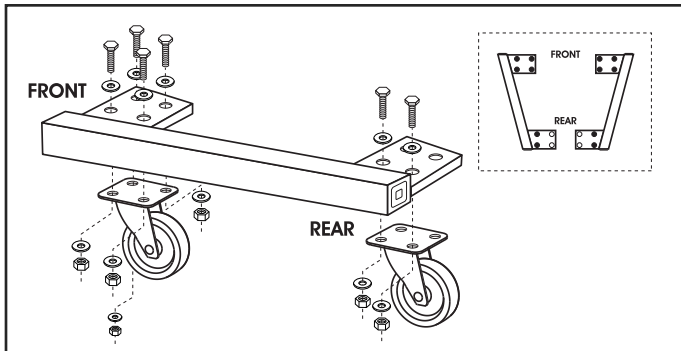

Figure 1

ATTACH MAIN POST TO LEG ASSEMBLIES

1. Lay black main post on ground and align mounting plate holes with rear leg assembly holes.
2. Use two (2) bolts on each side to secure post to leg assembly. (See Figure 2)
3. Tighten all locknuts securely.

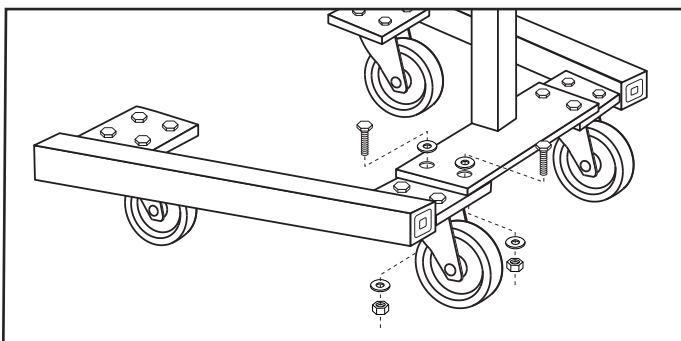

Figure 2

ATTACH FILM HOLDER

1. Stand Main Post upright.
2. Place Film Holder over top of post and slide all the way down. (See Figure 3)
3. Tighten knob on Film Holder to secure in place.

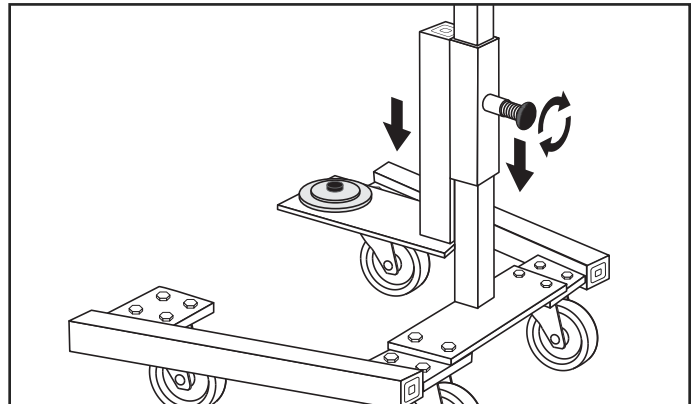

Figure 3

INSTALL STEERING HANDLE

1. Slide Steering Handle over Main Post. (See Figure 4)
2. Position to operator height. (Approximately waist level). Tighten knob to secure in place.

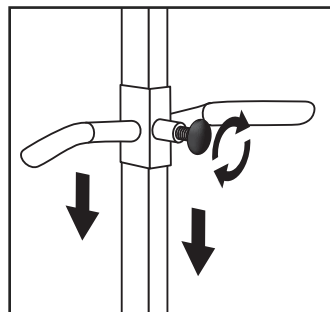

Figure 4

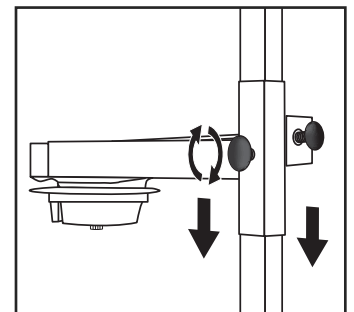

Figure 5

INSTALL TOP HEAD ASSEMBLY

1. Slide Top Head Assembly over Main Post.
2. Tighten the lock knob on Head Assembly. When film is installed, position Head Assembly 4" above film. (See Figure 5)

OPERATION

LOADING FILM INTO THE DISPENSER

1. Adjust Lower Film Holder to desired height. It can be adjusted to wrap the bottom of the pallet or adjusted to wrap at any position on the load.
2. To wrap pallet clockwise, place film on lower Film Holder so that the film will feed off roll counter clockwise. (See Figure 6)

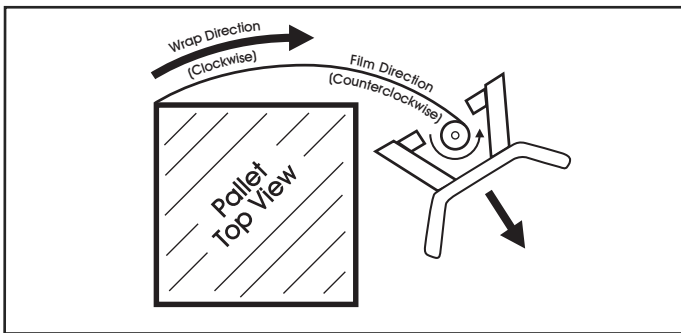

Figure 6

3. To wrap pallet counter-clockwise, place film on lower Film Holder so that the film will feed off roll clockwise.
4. Carefully lower head assembly onto film core and secure with knob.



CAUTION! No force is required because the Head Assembly has a self-locking core.

APPLYING FILM TO PALLET

1. With the Stretch Set™ knob in the off position, unroll film and attach securely to pallet.



NOTE: Tying a knot in the end of the film often helps secure film to pallet.

SETTING FILM STRETCH LEVEL

1. Engage Stretch Set™ by sliding knob down to the ON position. This engages the Film Stretch System.
2. To increase Stretch level, turn Stretch Set™ knob clockwise.



NOTE: Even ¼ turn (90°) adjustments noticeably increase film stretch. Stretch level will not change until more adjustments are made.

WRAPPING THE PALLET

1. Grab the cushioned steering arms.
2. While film is feeding off the roll, you must wrap your product by PULLING the dispenser around the pallet insuring the film will not come in contact with the lower legs of the dispenser. (See Figure 6)

FINISHING WRAPPING THE PALLET

1. Cutting the film approximately 12" past a corner is suggested. Note: It is easier to cut the film if Stretch Set™ is in the ON position. (See Figure 7)
2. Stretch film cuts easily if torn at a 45° degree angle to itself. (See Figure 8)

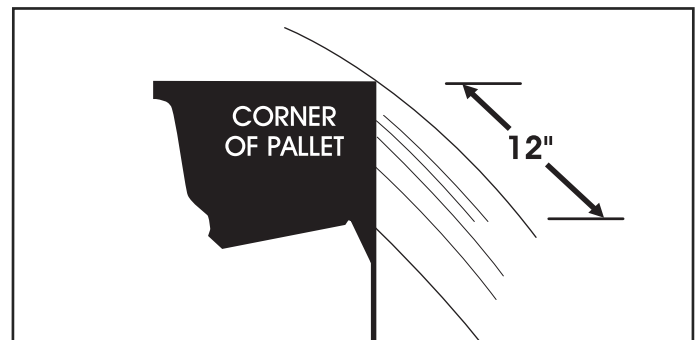

Figure 7

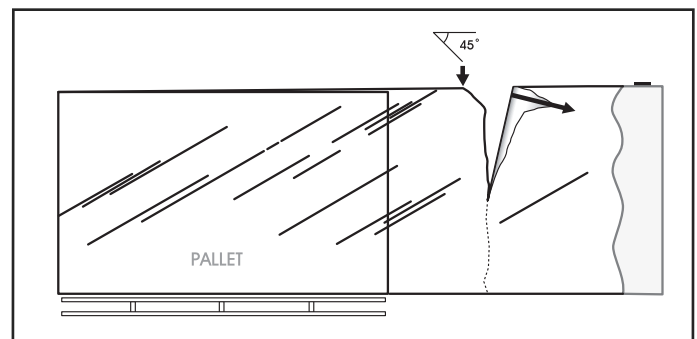

Figure 8

CHANGING FILM ROLLS

1. Rotate empty core ¼ turn in opposite direction of film feed. Core is now free.
2. Slide off top core assembly and remove empty roll.
3. Load new roll onto dispenser (see above).

OPERATION CONTINUED

WRAPPING TIPS

1. During wrapping, the film force pulls the dispenser in towards the pallet. To avoid, pull the Dispenser in a wide circle around the pallet.
2. At first, wrapping the pallet may require less stretch until the film secures the load.
3. If load heights vary, it may be easier to wrap the top of taller loads with a Handwrapper after wrapping the load with the portable Dispenser.

MAINTENANCE

Though the Portable Stretch Wrap Dispenser requires little maintenance, the following is recommended for trouble free operation.

AFTER FIRST 5 HOURS OF USE



NOTE: Tighten all fasteners!

AFTER EVERY 100 HOURS OF USE

1. The casters have a double ball-bearing system. In clean conditions, lubricate the casters with a grease gun at the grease fitting.
2. Lubricate the two flanged radial bearings on the Top Head Assembly with a light (30 weight) oil. (See parts diagram on page 2)



NOTE: be sure to clean off excess lubrication.

3. Lubricate the threaded portion of the steel rod on the Stretch Set™ knob with lithium grease
4. Tighten all fasteners.

ULINE

1-800-295-5510

uline.com